



# ÖLÇÜ KROKİSİ

ÖRNEK-18



DATUM : İNFA-88  
PROJEKSİYON : ZALITM-3  
KROKİ

Nokta No	Y	X	M/K
244/1	551992.32	4290811.66	0.09
244/2	551998.92	4290792.78	0.09
244/3	551986.42	4290788.41	0.09
244/4	551978.50	4290805.77	0.09
244/5	551978.88	4290806.96	0.09
244/6	552005.75	4290816.36	0.09
244/7	552030.21	4290813.84	0.09
244/8	552048.30	4290811.98	0.09
244/9	552060.24	4290810.76	0.09
244/10	552072.17	4290808.53	0.09
244/11	552084.12	4290807.24	0.09
244/12	552096.06	4290806.10	0.09
244/13	552119.95	4290804.96	0.09
244/14	552137.87	4290797.27	0.09
244/15	552011.77	4290789.45	0.09
244/16	552119.16	4290787.72	0.09
244/17	552137.24	4290784.87	0.09
244/18	552015.68	4290783.04	0.09
244/19	552015.85	4290781.86	0.09
244/20	552046.73	4290780.01	0.09
244/21	552028.63	4290777.61	0.09
244/22	552040.34	4290776.40	0.09
244/23	552046.73	4290775.20	0.09
244/24	552040.34	4290774.00	0.09
244/25	552070.61	4290772.47	0.09
244/26	552058.67	4290772.19	0.09
244/27	552082.55	4290764.86	0.09
244/28	551991.84	4290758.61	0.09
244/29	552094.49	4290756.80	0.09
244/30	552106.43	4290754.11	0.09
244/31	552118.37	4290752.29	0.09
244/32	552019.59	4290751.26	0.09
244/33	552136.35	4290749.80	0.09
244/34	551997.26	4290748.86	0.09
244/35	552117.57	4290747.59	0.09
244/36	552185.53	4290746.33	0.09
244/37	552001.73	4290745.51	0.09
244/38	552003.52	4290744.98	0.09
244/39	552025.95	4290743.45	0.09
244/40	552038.79	4290741.14	0.09
244/41	552057.13	4290741.14	0.09
244/42	552068.65	4290741.14	0.09
244/43	552069.08	4290741.14	0.09
244/44	552081.02	4290741.14	0.09
244/45	552092.96	4290741.14	0.09
244/46	552100.75	4290741.14	0.09
244/47	552104.89	4290741.14	0.09
244/48	552116.78	4290741.14	0.09
244/49	552134.69	4290741.14	0.09

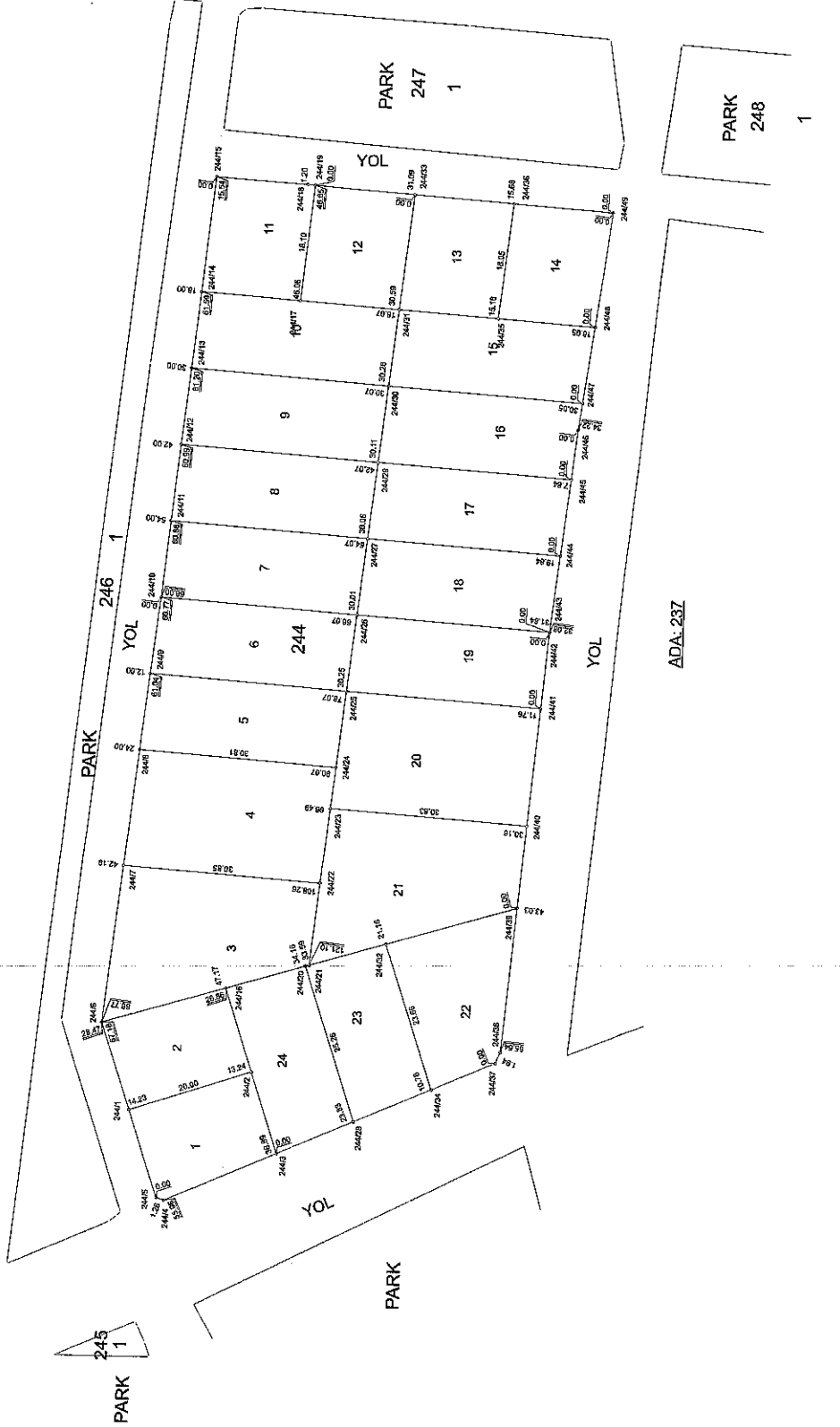

UYGUNDUR / (BELEDİYE / ÖZEL İDARE / PROJE İDARESİ)	KONTROL EDEN	ONAYLAYAN	KADASTRO MÜDÜRLÜĞÜ
			KONTROL EDİLMİŞTİR.
İL	MANİSA	ADİ SOYADI	
İLÇE	SARUHANLI	UNVAN	
KÖY/MAHALLE	HACIRAHMANLI	İMZA	
PARTE NO	K18-C-08-241/K18-C-08-243	TARİH	
ADA/PARSEL NO	244 ADA		

\* Yeni üretilen parsel köşe ve detay noktalarının